

# INDEX :

## RDA PLOTS AVAILABILITY STATUS

- [i] Commercial (Available)
- [ii] Commercial (Unacquired / Court case)
- [iii] Allotted plots

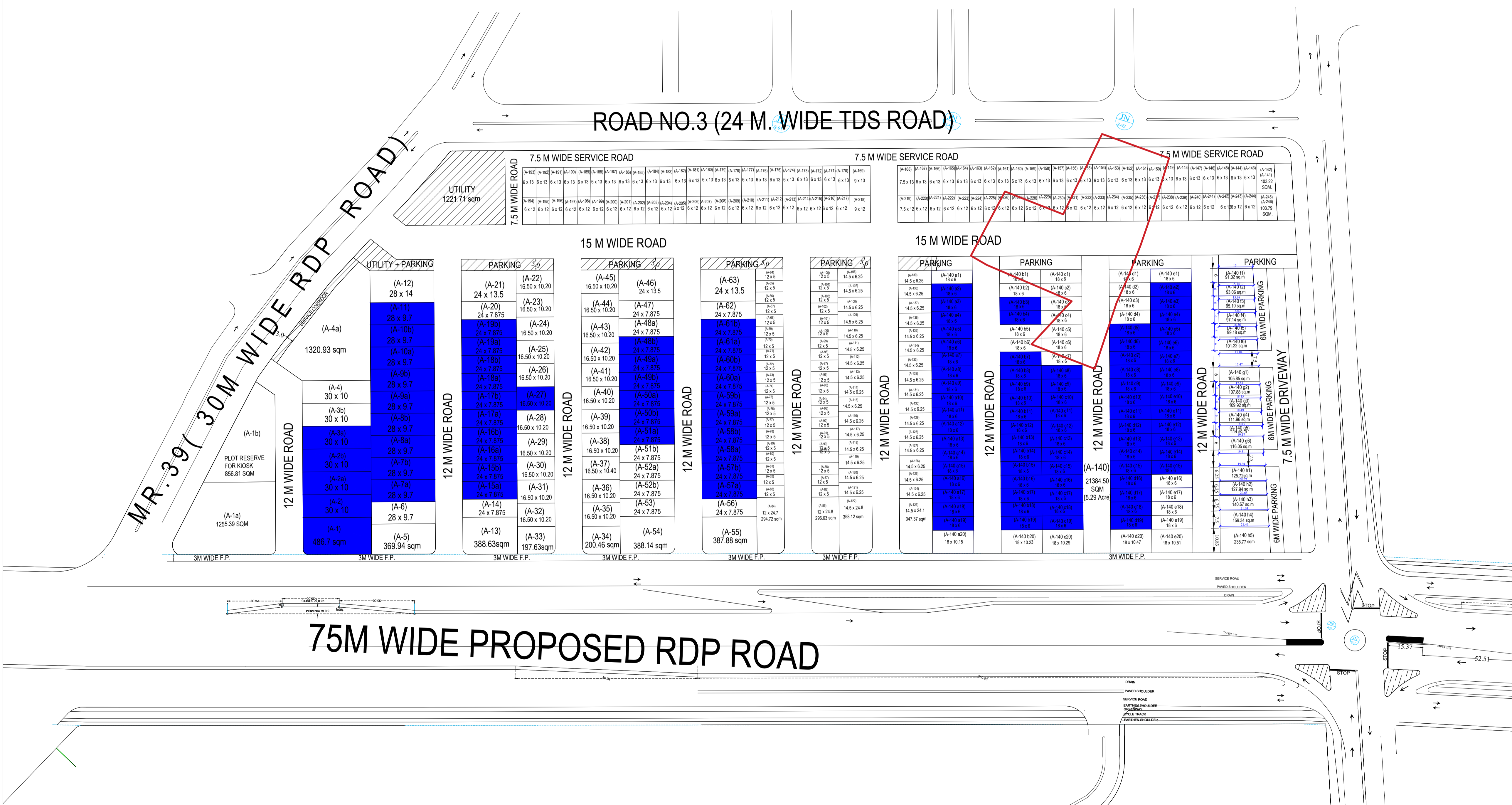

# SECTOR 7B

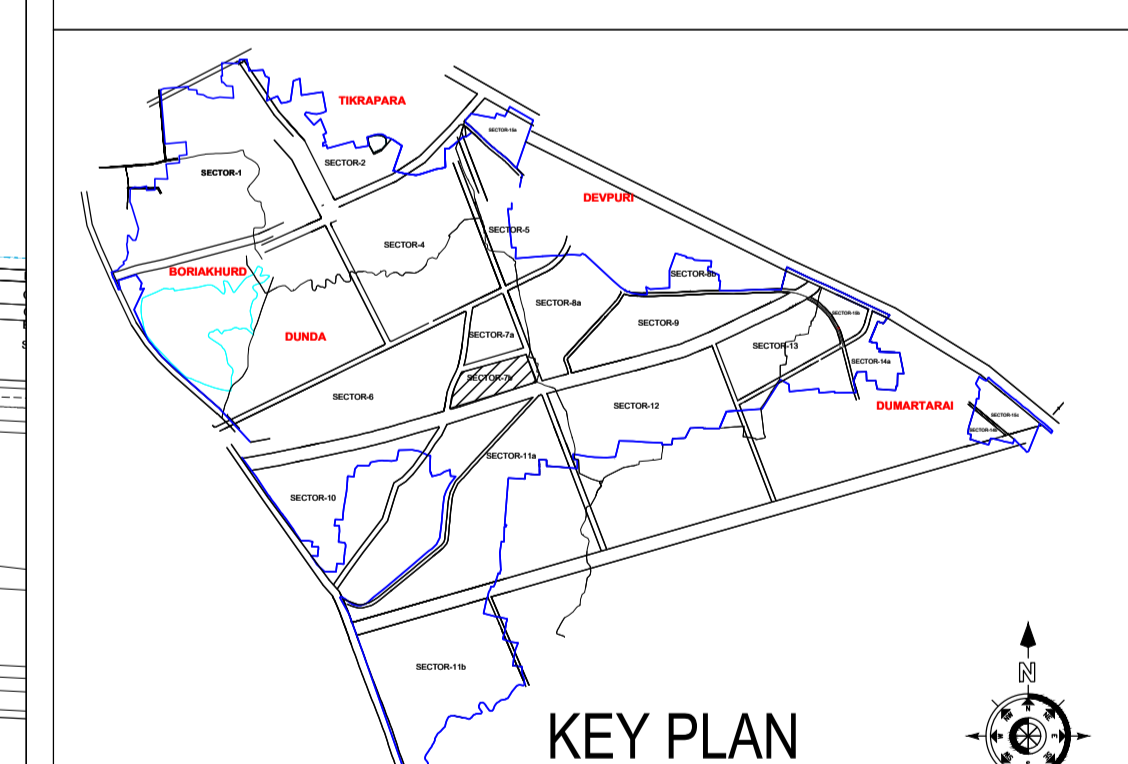

**TOWN DEVELOPMENT SCHEME- 04**  
**[ KAMAL VIHAR ]**  
 (PART OF VILLAGES DUNDA, TIKRAPARA, DEVPURI,  
 BORIYAKHURD AND DUMARTARAI)  
 TOTAL SCHEME AREA (TDS-04)= 647.84 HA  
**SECTOR - 7B**  
 FINAL LAYOUT PLAN

DRG. NO.	TDS-04 / FINAL / 2012 / L-7B/R5	REVISION - R5	
FOR PRINT ON A1 PAPER	<div style="display: flex; align-items: center;"> <div style="margin-right: 10px;">NORTH</div> </div>		
SCALE			1:2000
DATE			06.12.2017

**RAIPUR DEVELOPMENT AUTHORITY, RAIPUR [CG.]**

**TDS 4 KAMAL VIHAR RAIPUR [CG.]**

**RAIPUR DEVELOPMENT AUTHORITY**